

LOCATION DETAIL OF THE PROJECT OF LAND DEDICATED FOR THE PROJECT DEVELOPMENT ALONG WITH ITS BOUNDARIES INCLUDING THE LATITUDE & LONGITUDE OF END POINTS OF THE PROJECT

DEVELOPER: DHANDHANIA INFRASTRUCTURES PRIVATE LIMITED

PROJECT: MEERA RESIDENCY

31, NABAPALLY MAIN ROAD

(R.S. DAG NO.-2550 UNDER R.S. KHATIAN NO.-400, MOUZA-PURBA BARISHA, J.L. NO.-23, TOUZI NO.-1-6,8-10,12-16, P.O.-JOKA, P.S.-HARIDVEVPUR, DIST.-SOUTH 24 PARGANAS, KOLKATA-700108)

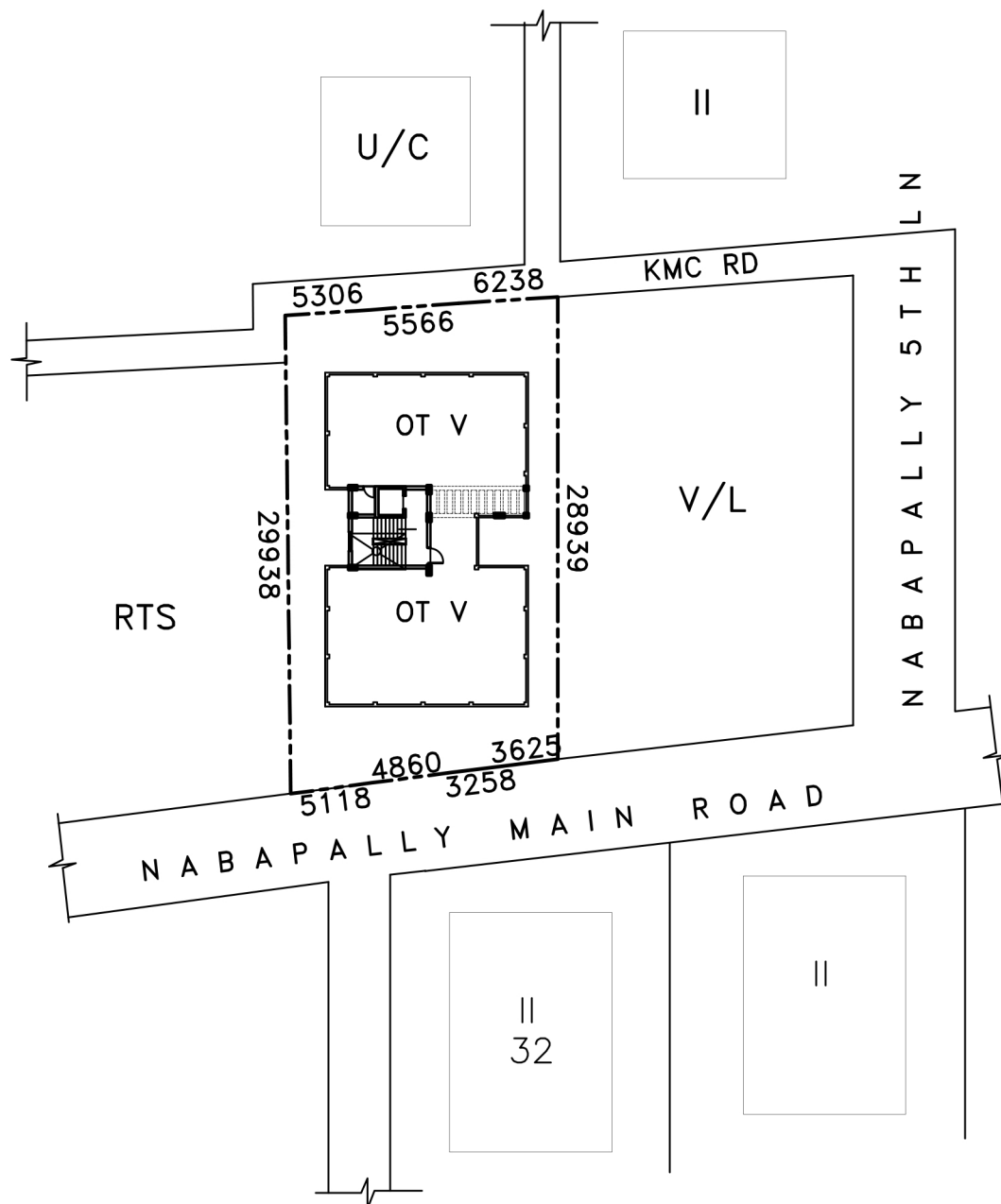

LOCATION MAP

SCALE-1:750

Moumita Majumder

MOUMITA MAJUMDER
REGISTERED ARCHITECT
REGN. NO. CA/2016/75681
SIGN OF ARCHITECT

LATITUDE: 22° 27' 13.3"N

LONGITUDE: 88° 18' 30.7"E

